

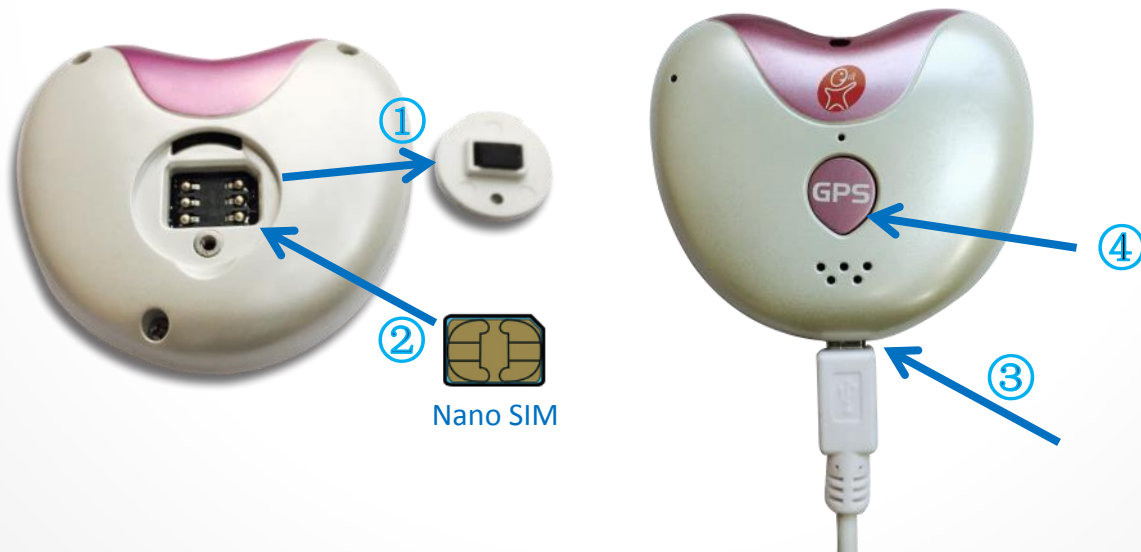

GPS SOS LOCATOR (BPA010) | Quick Start Guide
2016/11/25 updated

Set Up GPS

- ① Unscrew and open the back cover of the GPS;
- ② Insert a Nano SIM card and screw the cover back (should enable data service);
- ③ Charge the battery with USB cable;
- ④ Press the GPS button for about 3 seconds to turn on.



Download APP

- ① Download from App Store or Google Play by Searching “ProVista Care”;
- ② Or scan QR code with smart phone or tablet;



Android



Apple IOS

- ③ Or Click the following links:

Android: <http://www.provista-care.com/filedownload/爱家小哥GPS.apk>

IOS: <https://itunes.apple.com/cn/app/ai-jia-xiao-ge/id1073044239?mt=8;>

APP Register

- ① Click “Register now”
- ② Input phone number;
- ③ Click to get the identifying code SMS;
- ④ Set up password



Add GPS device to APP

- ① Click “Add Device”;
- ② Input GPS IMEI on the back of the GPS, and the SIM card numbers then “Submit”;
- ③ Click the “▽” icon on the top of the interface to show the added GPS device list.

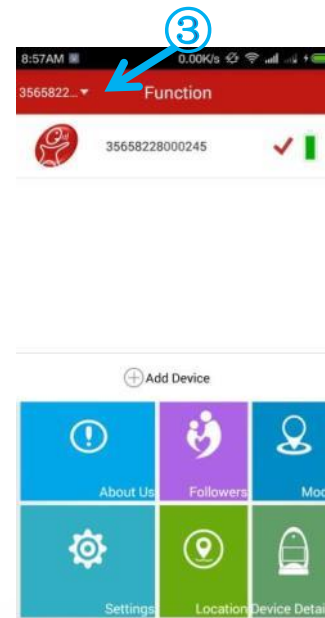

Add SOS Number

- ① Click “SOS”;
- ② Enter SOS phone numbers and click “Save”.



Tracking and Call GPS

- ① Click “Location” ;
- ② Update the location information;
- ③ Call the GPS;
- ④ Looking for the GPS device;
- ⑤ Check the historical track by date.

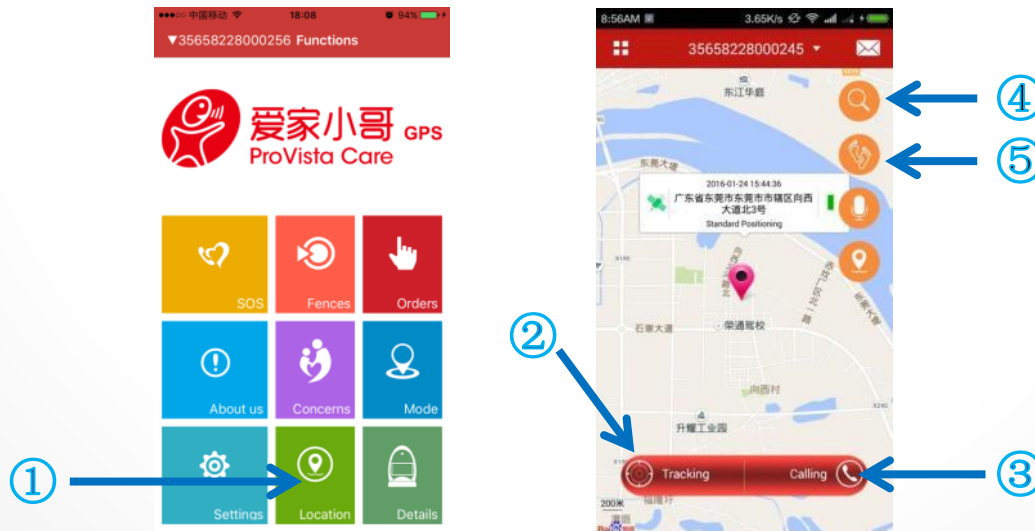

Remote Guardian (Silent listen-in)

- ① Click “Orders”;
- ② Click “Remote Guardian”;
- ③ Enter the intended phone number and click “OK” to authorize the GPS to call this number.

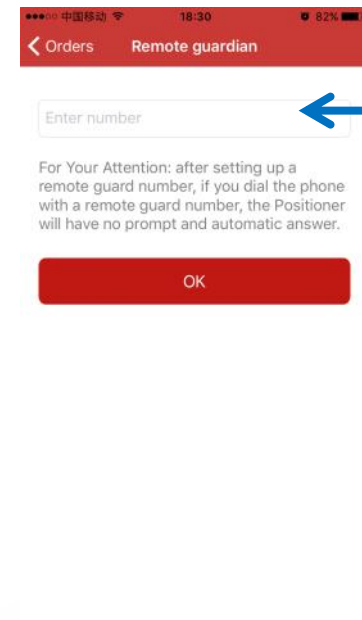
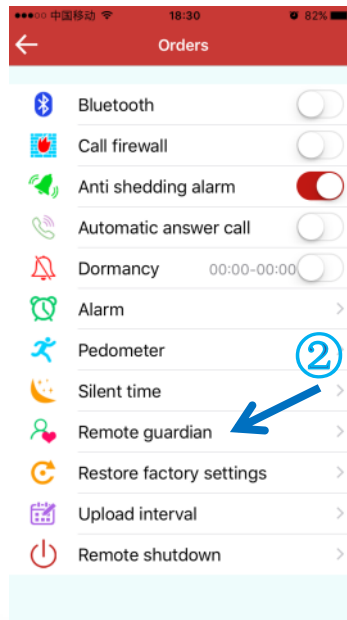

Remote Shut Down

- ① Click “Orders”;
- ② Click “Remote Shutdown” and click “OK” to confirm.

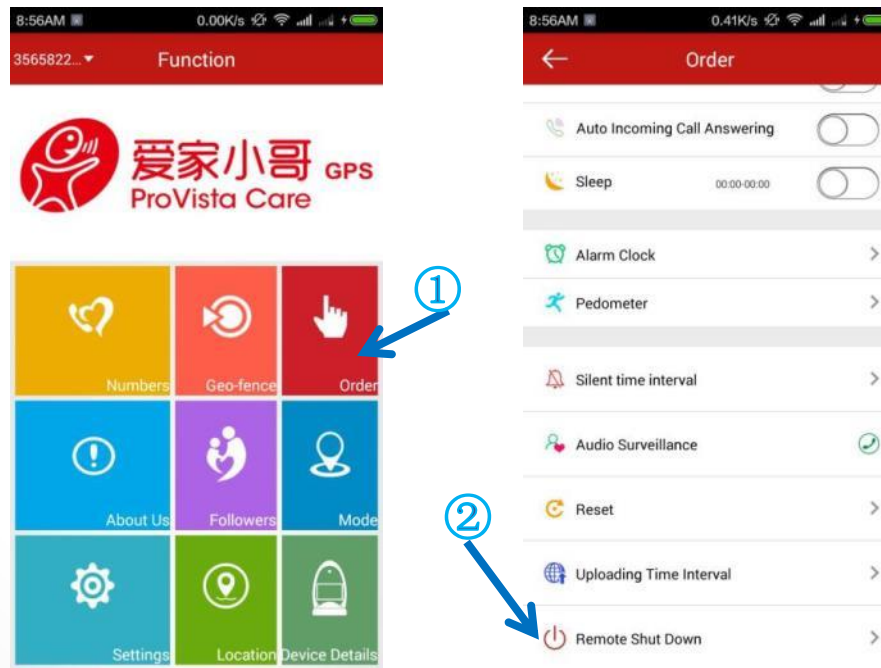

Invite Other People to Track the GPS

- ① Click “Concerns”;
- ② Click “+” ;
- ③ Enter the intended phone number and click “Invite”;
- ④ The invitation message will send to the invited APP, then click “Agree” to track the GPS.

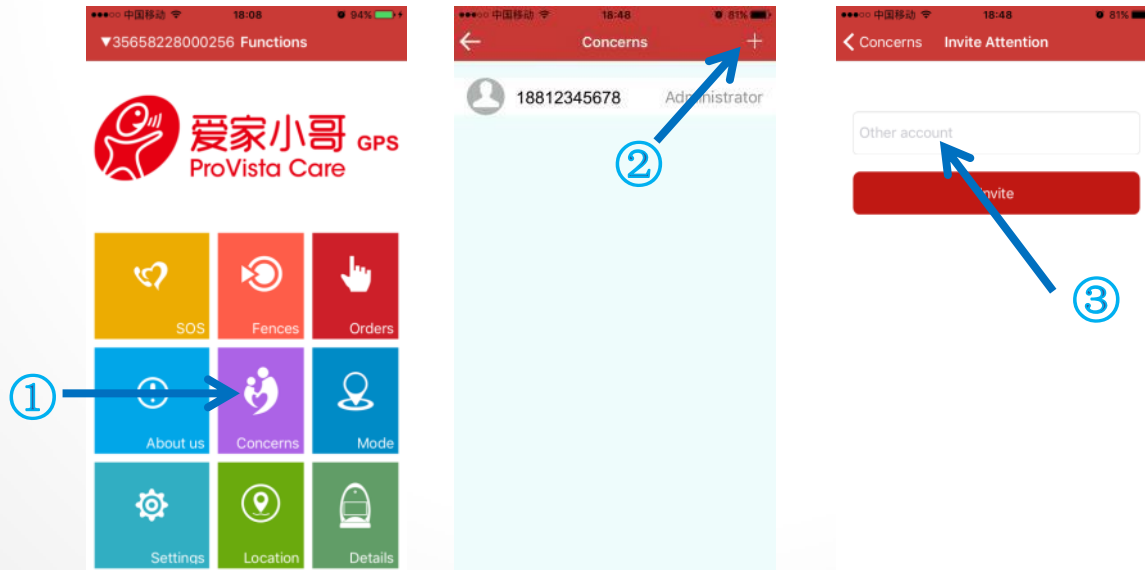



For more information, please download the user manual.